

Working for You...
AND THE STATE OF HAWAII

Senator Donovan M. Dela Cruz

HAWAII STATE SENATE - DISTRICT 22
Mililani Mauka • Wahiawā • Whitmore Village • Waipi'o Acres • Wheeler • Poamoho



June 2017

Chair: Committee on Ways and Means

Vice Chair: Committee on Transportation and Energy

Member: Committee on Education



You can view Senator Dela Cruz's senate website at www.capitol.hawaii.gov.



Subscribe to our E-Newsletter by emailing delacruz2@capitol.hawaii.gov.

David Cho, Legislative Aide
(808) 586-6697
d.cho@capitol.hawaii.gov

Tina Deitschman, Legislative Aide
(808) 586-6090
t.deitschman@capitol.hawaii.gov

Dot Fujinaga, Office Manager
(808) 586-6090
d.fujinaga@capitol.hawaii.gov

Hawaii State Senate
State Capitol
415 S. Beretania St., Rm. 208
Honolulu, HI 96813
P: 808-586-6090

Email:
sendelacruz@capitol.hawaii.gov

First Responders Technology Park & Cybersecurity Data Center

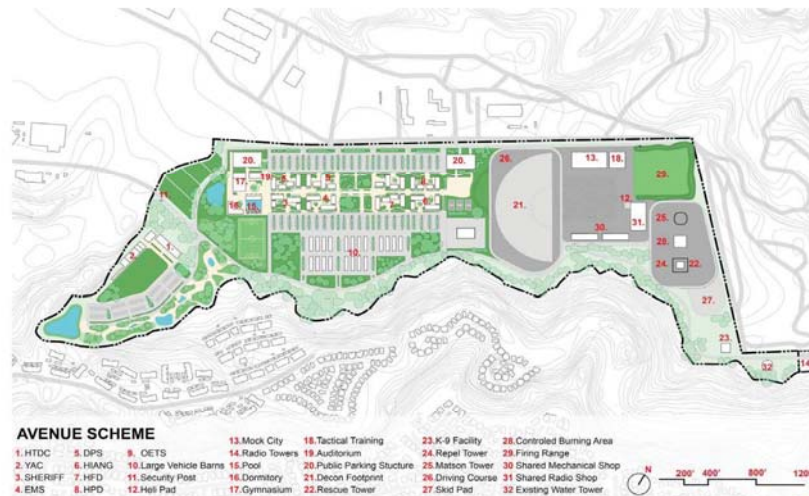

MASTER PLAN
FIRST RESPONDERS TECH CAMPUS



The High Technology Development Corporation will soon purchase Mililani Technology Park Phase II for the development of the First Responders Technology Campus and Cybersecurity Data Center.

The 150-acre parcel will house facilities for state and county first responders and a state data center, which are critically needed to ensure the public's safety and security needs for the state. Providing a consolidated facility for these agencies allows for joint training exercises and cost saving measures during a time when there are limited funds.

Ahead of the acquisition slated for this month, the Legislature dedicated an additional **\$900,000** in this year's state budget to design Phase I of the First Responders Technology Campus. Phase I entails training facilities which include a rescue and repel towers, firing range, driving course, buildings for tactical training, as well as many other features.

Working for the Community!



The Legislature continues to make agriculture a priority by supporting the Agribusiness Development Corporation's initiatives to revitalize agriculture in Central Oahu. Through the Whitmore Project, ADC is

Appropriations in the 2017 State Budget for the Whitmore Project:

- \$23.752 million to purchase an additional 600 acres of agricultural land in Central Oahu
- \$9 million for a value-added product development center
- \$650,000 to design a packing and processing facility in Whitmore Village
- \$500,000 to complete the design for a wastewater reclamation system at Wahiawa Wastewater Treatment Plant

For more information regarding the Whitmore Project please email our office at sendelacruz@capitol.hawaii.gov.

Rat lungworm cases are showing up in Hawai'i, but CTAHR Extension is on the job, informing the community about how to help prevent this worrying disease.

The UH Farm Food Safety website advises farmers and home gardeners to manage rats, slugs, and snails in fields and gardens and consumers to make sure they correctly wash and/or cook produce before eating.

They're partnering with the Department of Health, which is the lead agency educating the public about the parasite and health-related issues. Here is a list of approved slug and snail baits for commercial use in Hawai'i.



If you have any questions or concerns about rat lungworm infection, please contact the Director of the Hawai'i Department of Health on O'ahu: Phone: (808) 586-4410.